





		∅	∅	∅		
Codice SOLO GUSCI		mm	Pollici Gas	Pollici O.D.	Codice Con piastra Inf. + viti	Codice con piastra inf. Sup. + viti
C 1	C1-06	6			C1-06C	C1-06CS
	C1-1/4	6,4		1/4	C1-1/4C	C1-1/4CS
	C1-08	8		5/16	C1-08C	C1-08CS
	C1-3/8	9,5		3/8	C1-3/8C	C1-3/8CS
	C1-10	10	1/8		C1-10C	C1-10CS
	C1-12	12			C1-12C	C1-12CS
	C1-1/2	12,7		1/2	C1-1/2C	C1-1/2CS
C 2	C2-06	6			C2-06C	C2-06CS
	C2-1/4	6,4		1/4	C2-1/4C	C2-1/4CS
	C2-08	8		5/16	C2-08C	C2-08CS
	C2-3/8	9,5		3/8	C2-3/8C	C2-3/8CS
	C2-10	10	1/8		C2-10C	C2-10CS
	C2-12	12			C2-12C	C2-12CS
	C2-1/2	12,7		1/2	C2-1/2C	C2-1/2CS
C 3	C3-1/2	12,7		1/2	C3-1/2C	C3-1/2CS
	C3-1/4	13,5	1/4		C3-1/4C	C3-1/4CS
	C3-14	14			C3-14C	C3-14CS
	C3-15	15			C3-15C	C3-15CS
	C3-16	16		5/8	C3-16C	C3-16CS
	C3-3/8	17,2	3/8		C3-3/8C	C3-3/8CS
	C3-18	18			C3-18C	C3-18CS
C 4	C4-19	19		3/4	C4-19C	C4-19CS
	C4-20	20			C4-20C	C4-20CS
	C4-1/2	21,3	1/2		C4-1/2C	C4-1/2CS
	C4-22	22		7/8	C4-22C	C4-22CS
	C4-23	23			C4-23C	C4-23CS
	C4-25	25			C4-25C	C4-25CS
	C4-1	25,4		1	C4-1C	C4-1CS
C 5	C5-3/4	26,9	3/4		C5-3/4C	C5-3/4CS
	C5-29	29			C5-29C	C5-29CS
	C5-28	28			C5-28C	C5-28CS
	C5-30	30			C5-30C	C5-30CS
	C5-32	32		1.1/4	C5-32C	C5-32CS
C 6	C6-32	32			C6-32C	C6-32CS
	C6-1	33,7	1"		C6-1C	C6-1CS
	C6-35	35			C6-35C	C6-35CS
	C6-38	38		1.1/2	C6-38C	C6-38CS
	C6-40	40			C6-40C	C6-40CS
	C6-11/4	42,4	1.1/4		C6-11/4C	C6-11/4CS
	C6-45	45			C6-45C	C6-45CS
C 7	C7-45	45			C7-45C	C7-45CS
	C7-1.1/2	48,3	1.1/2		C7-1.1/2C	C7-1.1/2CS
	C7-50	50			C7-50C	C7-50CS
	C7-2	50,8			C7-2C	C7-2CS
	C7-53	53		2"	C7-53C	C7-53CS
	C7-54	54	1.3/4		C7-54C	C7-54CS
C 8	C8-2.1/4	57,2		2.1/4	C8-2.1/4C	C8-2.1/4CS
	C8-2	60,3	2"		C8-2C	C8-2CS
	C8-2.1/2	63,5		2.1/2	C8-2.1/2C	C8-2.1/2CS
	C8-66	66			C8-66C	C8-66CS
	C8-70	70		2.3/4	C8-70C	C8-70CS
	C8-73	73			C8-73C	C8-73CS
	C8-3	76,1	2.1/2	3	C8-3C	C8-3CS
C 9	C9-102	88,9	3	3.1/2	C9-102C	C9-102CS
	C9-4	102	3.1/2	4	C9-4C	C9-4CS

							
			Ø mm	Ø Pollici Gas	Ø Pollici O.D.		
		Codice SOLO GUSCI				Codice Con piastra Inf. + viti	Codice con piastra inf. Sup. + viti
<b>CF1</b>	CF1-6	6-6				CF1-6C	CF1-6CS
	CF1-1/4	6,4-6,4			1/4-1/4	CF1-1/4C	CF1-1/4CS
	CF1-8	8-8			5/16-5/16	CF1-8C	CF1-8CS
	CF1-3/8	9,5-9,5			3/8-3/8	CF1-3/8C	CF1-3/8CS
	CF1-10	10-10	1/8-1/8			CF1-10C	CF1-10CS
	CF1-12	12-12				CF1-12C	CF1-12CS
	CF1-1/2	12,7-12,7			1/2-1/2	CF1-1/2C	CF1-1/2CS
<b>CF2</b>	CF2-1/2	12,7-12,7			1/2-1/2	CF2-1/2C	CF2-1/2CS
	CF2-1/4	13,5-13,5	1/4-1/4			CF2-1/4C	CF2-1/4CS
	CF2-14	14-14				CF2-14C	CF2-14CS
	CF2-15	15-15				CF2-15C	CF2-15CS
	CF2-16	16-16			5/8-5/8	CF2-16C	CF2-16CS
	CF2-3/8	17,2-17,2	3/8-3/8			CF2-3/8C	CF2-3/8CS
	CF2-18	18-18				CF2-18C	CF2-18CS
<b>CF3</b>	CF3-19	19-19			3/4-3/4	CF3-19C	CF3-19CS
	CF3-20	20-20				CF3-20C	CF3-20CS
	CF3-1/2	21,3-21,3	1/2-1/2			CF3-1/2C	CF3-1/2CS
	CF3-22	22-22			7/8-7/8	CF3-22C	CF3-22CS
	CF3-23	23-23				CF3-23C	CF3-23CS
	CF3-25	25-25				CF3-25C	CF3-25CS
	CF3-1	25,4-25,4			1-1	CF3-1C	CF3-1CS
<b>C F4</b>	CF4-26	26-26				CF4-26C	CF4-26CS
	CF4-3/4	26,9-26,9	3/4-3/4			CF4-3/4C	CF4-3/4CS
	CF4-28	28-28				CF4-28C	CF4-28CS
	CF4-30	30-30				CF4-30C	CF4-30CS
<b>CF5</b>	CF5-32	32-32			1.1/4-1.1/4	CF5-32C	CF5-32CS
	CF5-1	33,7-33,7	1-1			CF5-1C	CF5-1CS
	CF5-35	35-35				CF5-35C	CF5-35CS
	CF5-38	38-38			1.1/2-1,1/2	CF5-38C	CF5-38CS
	CF5-40	40-40				CF5-40C	CF5-40CS
	CF5-1.1/4	42,4-42,4	1.1/4-1.1/4			CF5-1.1/4C	CF5-1.1/4CS

						
			∅ mm	∅ Pollici Gas	∅ Pollici O.D.	
		Codice SOLO GUSCI				Codice Con piastra Inf. Sup + viti
CP1	CP1-06	6				CP1-06C
	CP1-1/4	6,4		1/4		CP1-1/4C
	CP1-8	8				CP1-8C
	CP1-10	10	1/8			CP1-10C
	CP1-12	12				CP1-12C
	CP1-14	14				CP1-14C
	CP1-15	15				CP1-15C
	CP1-16	16		5/8		CP1-16C
	CP1-3/8	17,2	3/8			CP1-3/8C
	CP1-18	18				CP1-18C
	CP1-19	19				CP1-19C
CP1-20	20				CP1-20C	
CP2	CP2-19	19		3/4		CP2-19C
	CP2-20	20				CP2-20C
	CP2-1/2	21,3	1/2			CP2-1/2C
	CP2-22	22		7/8		CP2-22C
	CP2-25	25				CP2-25C
	CP2-1	25,4		1		CP2-1C
	CP2-3/4	26,9	3/4			CP2-3/4C
	CP2-28	28				CP2-28C
CP2-30	30				CP2-30C	
CP3	CP3-30	30				CP3-30C
	CP3-32	32		1.1/4		CP3-32C
	CP3-1	33,7	1			CP3-1C
	CP3-35	35				CP3-35C
	CP3-36	36				CP3-36C
	CP3-38	38		1.1/2		CP3-38C
	CP3-40	40				CP3-40C
	CP3-1.1/4	42,4	1.1/4			CP3-1.1/4C
	CP3-43	43				CP3-43C
CP3-45	45				CP3-45C	
CP4	CP4-1	33,7	1			CP4-1C
	CP4-38	38		1.1/2		CP4-38C
	CP4-40	40				CP4-40C
	CP4-1.1/4	42,4	1.1/4			CP4-1.1/4C
	CP4-45	45		1.3/4		CP4-45C
	CP4-1.1/2	48,3	1.1/2			CP4-1.1/2C
	CP4-50	50				CP4-50C
	CP4-2	50,8		2		CP4-2C
	CP4-53	53				CP4-53C
	CP4-54	54	1.3/4			CP4-54C
	CP4-55	55				CP4-55C
	CP4-56	56				CP4-56C
	CP4-2.1/4	57,2		2.1/4		CP4-2.1/4C
	CP4-2.1/2	63,5		2.1/2		CP4-2.1/2C
CP4-65	65				CP4-65C	
CP4-70	70		2.3/4		CP4-70C	
CP5	CP5-2	60,3	2			CP5-2C
	CP5-65	65				CP5-65C
	CP5-66	66	2.1/4			CP5-66C
	CP5-70	70		2.3/4		CP5-70C
	CP5-73	73				CP5-73C
	CP5-2.1/2	76,1	2.1/2	3		CP5-2.1/2C
	CP5-80	80				CP5-80C
	CP5-85	85				CP5-85C
	CP5-3	88,9	3	3.1/2		CP5-3C
CP5-90	90				CP5-90C	
CP6	CP6-100	100				CP6-100C
	CP6-4	101,6		4		CP6-4C
	CP6-102	102	3.1/2			CP6-102C
	CP6-108	108		4.1/4		CP6-108C
	CP6-114	114	4	4.1/2		CP6-114C
	CP6-121	121				CP6-121C
	CP6-4.1/2	126,5	4.1/2			CP6-4.1/2C





## GIUNTI GIREVOLI A 90° DA 1/4" A 1"

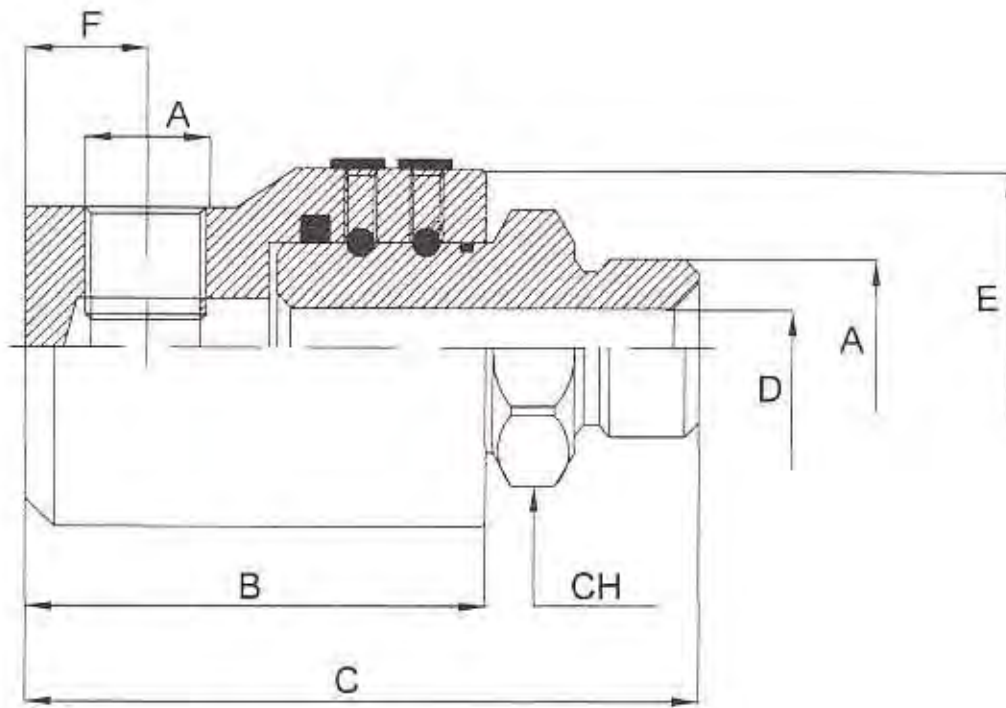

### DIMENSIONI

NB: Ulteriori filettature disponibili a richiesta

CODICE	A	B	C	D	Ø E	F	CH	PRESSIONE MASSIMA DI ROTAZIONE	PRESSIONE MASSIMA STATICA
		mm	mm	mm	mm	mm	mm	bar	bar
GG9014	1/4"	50	69	6	33.5	11	19	200	400
GG9038	3/8"	54	76	8.5	37.5	13	24	200	400
GG9012	1/2"	63	87	11.5	39.5	14	27	150	300
GG9034	3/4"	70	100	15	54.5	18	34	150	300
GG901	1"	80	113	21	55/60	25	41	100	300



## O-RING

Codice: **0301.. NBR**  
Codice: **0302.. VITON®**

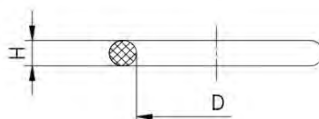

### CONO DIN 24°

Codice		D	H	ØTubo
NBR	VITON®			
030102	030202	4	1,5	6L/S
030104	030204	6	1,5	8L/S
030105	030205	7,5	1,5	10L/S
030110	030210	9	1,5	12L/S
030113	030213	10	2	14S
030119	030219	12	2	15L/16S
030124	030224	15	2	18L
030127	030227	16,3	2,4	20S
030134	030234	20	2	22L
030135	030235	20,3	2,4	25S
030141	030241	25,3	2,4	30S
030142	030242	26	2	28L
030148	030248	32	2,5	35L
030149	030249	33,3	2,4	38S
030154	030254	38	2,5	42L

### ANELLI "B4"

Codice		D	H	ØTubo
NBR	VITON®			
030103	030203	6	1	6L/S
030107	030207	8	1	8L/S
030112	030212	10	1	10L/S
030118	030218	12	1	12L/S
030122	030222	14	1	14S
030123	030223	15	1	15L
030126	030226	16	1	16S
030130	030230	18	1	18L
030133	030233	20	1	20S
030136	030236	22	1	22L
030140	030240	25	1	25S
030143	030243	28	1	28L
030147	030247	30	1	30S
030150	030250	35	1	35L
030153	030253	38	1	38S
030156	030256	42	1	42L

### FRONTALE SERIE 3000/6000 PSI

Codice		D	H	ØTubo
NBR	VITON®			
030181	030281	18,64	3,53	1/2
030182	030282	24,99	3,53	3/4
030183	030283	32,92	3,53	1
030184	030284	37,69	3,53	1 1/4
030185	030285	47,22	3,53	1 1/2
030186	030286	56,74	3,53	2

### RONDELLE PORTAMANOMETRO B4

Codice		D	H	Filetto
NBR	VITON®			
030103	030203	6	1	G 1/4
030118	030218	12	1	G 1/2

### CONO BS 5200 60° GAS

Codice		D	H	Dado
NBR	VITON®			
030101	030201	4	1	G 1/8
030103	030203	6	1	G 1/4
030107	030207	8	1	G 3/8
030118	030218	12	1	G 1/2
030126	030226	16	1	G 5/8
030130	030230	18	1	G 3/4
030136	030236	22	1	G 1
030147	030247	30	1	G 1 1/4
030150	030250	35	1	G 1 1/2
030168	030268	48	1	G 2

### CONO BS 5200 60° METRICO

Codice		D	H	Dado
NBR	VITON®			
030101	030201	4	1	M12x1,5
030103	030203	6	1	M14x1,5
030107	030207	8	1	M16x1,5
030112	030212	10	1	M18x1,5
030118	030218	12	1	M20x1,5
030122	030222	14	1	M22x1,5
030130	030230	18	1	M26x1,5
030136	030236	22	1	M30x1,5
030143	030243	28	1	M38x1,5
030180	030280	32	1	M45x1,5

### FRONTALE ORFS

Codice		D	H	ØTubo
NBR	VITON®			
030170	030270	7,65	1,78	6
030171	030271	9,25	1,78	8-10
030172	030272	12,42	1,78	12
030173	030273	15,6	1,78	14-15-16
030174	030274	18,77	1,78	18-20
030175	030275	23,52	1,78	22-25
030176	030276	29,87	1,78	28-30-32
030177	030277	37,82	1,78	35-38

### FILETTO GAS CILINDRICO

Codice		D	H	Filetto
NBR	VITON®			
030106	030206	7,97	1,88	G 1/8
030115	030215	10,77	2,62	G 1/4
030121	030221	13,94	2,62	G 3/8
030129	030229	17,86	2,62	G 1/2
030137	030237	23,47	2,62	G 3/4
030146	030246	29,74	3,53	G 1
030152	030252	37,69	3,53	G 1 1/4
030158	030258	44,04	3,53	G 1 1/2
030160	030260	55,56	3,53	G 2

### FILETTO METRICO CILINDRICO

Codice		D	H	Filetto
NBR	VITON®			
030108	030208	8,1	1,6	M10x1
030111	030211	9,3	2,2	M12x1,5
030116	030216	11,3	2,2	M14x1,5
030120	030220	13,3	2,2	M16x1,5
030125	030225	15,3	2,2	M18x1,5
030169	030269	17,3	2,2	M20x1,5
030132	030232	19,3	2,2	M22x1,5
030139	030239	23,6	2,9	M27x2
030144	030244	29,6	2,9	M33x2
030155	030255	38,6	2,9	M42x2
030159	030259	44,6	2,9	M48x2

### FILETTO UNF/UN - 2A

Codice		D	H	ØTubo
NBR	VITON®			
030109	030209	8,92	1,83	7/16-20
030114	030214	10,52	1,83	1/2-20
030117	030217	11,9	1,98	9/16-18
030128	030228	16,36	2,2	3/4-16
030131	030231	19,18	2,46	7/8-14
030138	030238	23,47	2,95	1 1/16-12
030145	030245	29,74	2,95	1 5/16-12
030151	030251	37,46	3	1 5/8-12
030157	030257	43,69	3	1 7/8-12

### INTERNO VALVOLE DI RITEGNO

Codice		D	H	TIPO	APPLICAZIONE
NBR	VITON®				
030161	030261	60	2,62	Corpo	Ø Tubo DIN 35L,42L, 30S, 38S Ø Tubo JIC 37° 30,32, 38 Filetto femmina: Gas 1 1/4, Gas 1 1/2, NPT 1 1/4, NPT 1 1/2, M42x2, M48x2

Note: VITON® è un marchio registrato dalla DuPont Dow Elastomers.



## GUARNIZIONE PIANA PER TUTTE LE SERIE - Filetto gas cilindrico - Filetto metrico cilindrico

Codice: **0303.. NBR**

Codice: **0304.. VITON®**

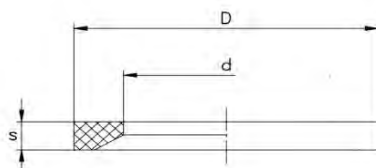

Ordinazione NBR	Ordinazione VITON®	Filetto metrico	Filetto gas	D	d	s
030301	030401	8x1		9,9	6,5	1
030302	030402	10x1	1/8	11,9	8,4	1
030303	030403	12x1,5		14,4	9,8	1,5
030304	030404	14x1,5	1/4	16,5	11,6	1,5
030305	030405	16x1,5		18,9	13,8	1,5
030306	030406		3/8	18,9	14,7	1,5
030307	030407	18x1,5		20,9	15,7	1,5
030308	030408	20x1,5		22,9	17,8	1,5
030309	030409		1/2	23,9	18,5	1,5
030310	030410	22x1,5		24,3	19,6	1,5
030311	030411	26x1,5 - 27x2	3/4	29,2	23,9	1,5
030312	030412	33x2	1	35,7	29,7	2
030313	030413	42x2	1 1/4	45,8	38,8	2
030314	030414	48x2	1 1/2	50,7	44,7	2

## GUARNIZIONE DI TENUTA PER ANELLO B4

Codice: **0305.. NBR**

Codice: **0306.. VITON®**

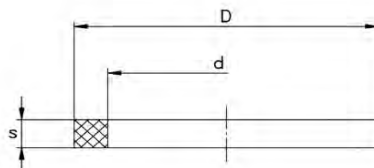

Ordinazione NBR	Ordinazione VITON®	Ø tubo	D	d	s
030501	030601	6L	9	7,3	3,5
030502	030602	6S	11	7,3	3,5
030503	030603	8L	11	9,3	3,5
030504	030604	8S	13	9,3	3,5
030505	030605	10L	12	10,5	4
030506	030606	10S	14	10,5	4
030507	030607	12L	13,7	12	4
030508	030608	12S	16	12	4
030509	030609	14S	18,5	15	3
030510	030610	15L	17,5	15	3
030511	030611	16S	19,5	16	3,5
030512	030612	18L	21,5	18	3,5
030513	030613	20S	25	20,6	3,5
030514	030614	22L	25	22	3,5
030515	030615	25S	30,5	25,1	4
030516	030616	28L	30,5	27,5	4
030517	030617	30S	36,5	30,2	3,5
030518	030618	35L	39,5	35,2	4
030519	030619	38S	46,5	38,2	3,5
030520	030620	42L	46,5	42,2	3,5

**Note:** VITON® è un marchio registrato dalla DuPont Dow Elastomers.

**SPIRALE DI PROTEZIONE****Specifiche Tecniche:**

Spirale realizzata in polietilene ad alta densità, pratica rapida e semplice nel montaggio. Indicata per la protezione di uno o più tubi; buona resistenza all'abrasione ed ai raggi U.V.

**Temperatua d'utilizzo:**

Da -20°C a +100 °C      da -4°F a + 212°F

<b>Codice</b>	<b>Dn. Esterno mm</b>	<b>Spessore Medio mm</b>	<b>Larghezza Bandella mm</b>	<b>Peso g/m</b>	<b>Gamma Diametri Tubi</b>
<b>SZ128</b>	12,0	1,5	10,0	46	10-17
<b>SZ1612</b>	16,0	1,5	12,0	60	12-22
<b>SZ2016</b>	20,0	1,8	14,5	73	16-27
<b>SZ2520</b>	25,0	2,0	21,0	112	22-35
<b>SZ3227</b>	32,0	2,0	24,0	143	27-43
<b>SZ4036</b>	40,0	2,5	30,0	217	33-55
<b>SZ5044</b>	50,0	3,0	35,0	278	42-64
<b>SZ6356</b>	63,0	3,5	40,0	588	52-75
<b>SZ7567</b>	75,0	3,4	40,0	813	65-96
<b>SZ9080</b>	90,0	5,0	45,0	1033	80-125

## GUAINE TESSILI DI PROTEZIONE



### Specifiche Tecniche:

Guaina Tessile ad alta tenacità, indicata per il contenimento di tubi singoli o multipli.  
Ottima resistenza alle sollecitazioni meccaniche, così come la compatibilità con oli e prodotti organici.

Buona tenuta all'abrasione secondo ISO 6945.

### Temperatura d'esercizio:

Da -40°C a + 100 °C      da -40°F a + 212°F

<b>Codice</b>	<b>Larghezza mm</b>	<b>Dn. Mm</b>	<b>Peso g/m</b>
GT35	35	20	27
GT40	40	22	32
GT45	45	25	34
GT50	50	28	38
GT55	55	32	42
GT60	60	35	45
GT65	65	38	48
GT80	80	45	60
GT90	90	50	65
GT120	120	70	96
GT150	150	90	112

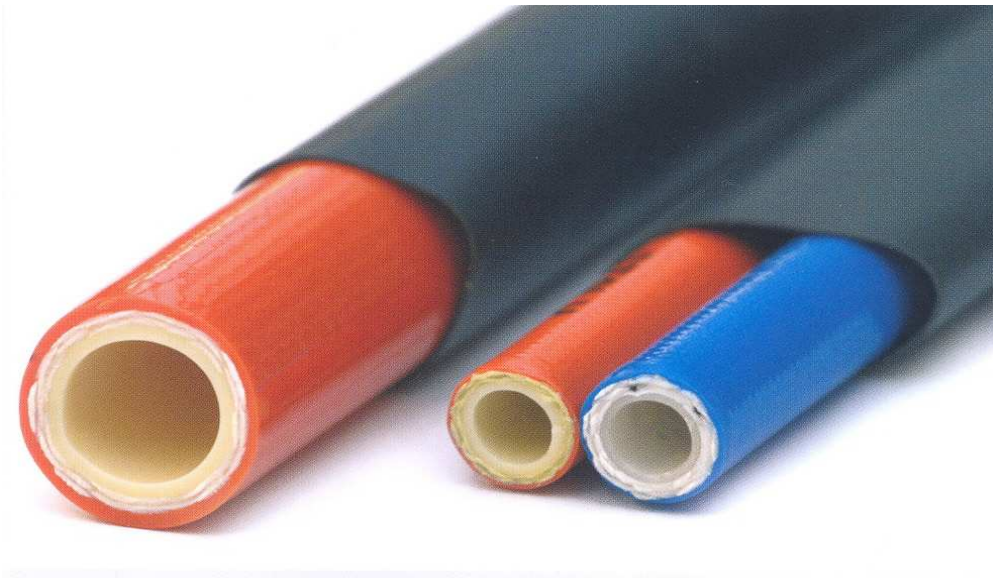
**GUAINE DI PROTEZIONE IN PVC****Temperatura d'esercizio:**

Da -15°C a + 70 °C      da + 5°F a + 158°F

<b>Codice</b>	<b>Dn. Interno mm</b>	<b>Spessore mm</b>	<b>Peso g/m</b>
GZ10	10,00	0,5	26,00
GZ16	16,00	0,5	39,00
GZ18	18,00	0,5	52,00
GZ20	20,00	0,6	58,00
GZ22	22,00	0,6	63,00
GZ25	25,00	0,6	72,00
GZ28	28,00	0,6	82,00
GZ30	30,00	0,6	87,00
GZ33	33,00	0,7	104,00
GZ38	38,00	0,7	135,00
GZ40	40,00	0,7	141,00
GZ45	45,00	0,7	144,00
GZ50	50,00	0,7	167,00
GZ55	55,00	0,7	184,00

## RONDELLE BONDED SEALS GAS

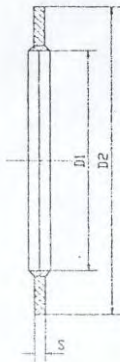

CODICE	FIL.	D1	D2	S	Q.TA' conf.
<b>RFG 18</b>	1/8"	10.30	16.00	2.1	100
<b>RFG 14</b>	1/4"	13.70	20.70	2.1	100
<b>RFG 38</b>	3/8"	17.25	23.95	2.1	100
<b>RFG 12</b>	1/2"	21.50	28.70	2.5	100
<b>RFG 34</b>	3/4"	27.05	35.05	2.5	100
<b>RFG 1</b>	1"	33.85	42.95	3.4	50
<b>RFG 114</b>	1 1/4"	42.90	52.50	3.4	40
<b>RFG 112</b>	1 1/2"	48.40	58.75	3.4	30
<b>RFG 2</b>	2"	60.60	73.13	3.4	10

## RONDELLE RAME GAS

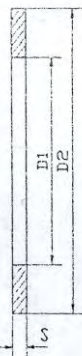

CODICE	FIL.	D1	D2	S	Q.TA' conf.
<b>RRG 18</b>	1/8"	10	14	1	100
<b>RRG 14</b>	1/4"	13.5	18	1.5	100
<b>RRG 38</b>	3/8"	17.0	23	1.5	100
<b>RRG 12</b>	1/2"	21.5	27	1.5	100
<b>RRG 34</b>	3/4"	27.0	33	1.5	100
<b>RRG 1</b>	1"	33.5	40	1.5	100
<b>RRG 114</b>	1 1/4"	42.0	50	1.5	50
<b>RRG 112</b>	1 1/2"	48.0	56	1.5	50
<b>RRG 2</b>	2"				

## RONDELLE BONDED SEALS METRICHE

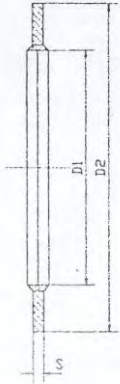

CODICE	FIL.	D1	D2	S	Q.TA' conf.
<b>RFM08</b>	M08				
<b>RFM 10</b>	M10	10.70	16.00	1.5	100
<b>RFM 12</b>	M12	12.70	20.00	1.5	100
<b>RFM 14</b>	M14	14.85	22.30	1.5	100
<b>RFM 16</b>	M16	16.51	25.50	2.1	100
<b>RFM 18</b>	M18	18.15	25.55	1.5	100
<b>RFM 20</b>	M20	20.70	28.00	1.5	50
<b>RFM 22</b>	M22	23.49	31.90	2.0	50
<b>RFM 24</b>	M24	24.25	33.40	2.0	50

## RONDELLE RAME METRICHE



CODICE	FIL.	D1	D2	S	Q.TA' conf.
<b>RRM 06</b>	6.0	6.0	12	1.5	100
<b>RRM 08</b>	8.0	8.0	14	1.5	100
<b>RRM 10</b>	10.0	10.0	16	1.5	100
<b>RRM 12</b>	12.0	12.0	16	1.5	100
<b>RRM 14</b>	14.0	14.0	20	1.5	100
<b>RRM 16</b>	16.0	16.0	22	1.5	100
<b>RRM 18</b>	18.0	18.0	24	1.5	100
<b>RRM 20</b>	20.0	20.0	26	1.5	100
<b>RRM 22</b>	22.0	22.0	28	1.5	100
<b>RRM 24</b>	24.0	24.0	30	1.5	100
<b>RRM26</b>	26.0	26.0	32	1.5	100
<b>RRM28</b>	28.0	28.0	34	1.5	100
<b>RRM 30</b>	30.0	30.0	36	1.5	100